

FATOS-LED

LED Inset Final Approach & Takeoff Light

Compliance with Standards

CAAC:AC-137-CA-2017-01-R1
 SAC: GB/T 7256
 ICAO: Annex 14, Volume II
 IEC: TS61827
 FAA: AC 150/5345-46 & EB NO.87
 ICAO: Aerodrome Design Manual- Part 4

Application/Use

Final Approach & Takeoff Light of Heliport

Features

- Long working life LED, energy conversation, maintenance-free, which brings enormous economic benefits to customers;
- Special designed LED lens is adopted to greatly improve LED light efficiency;
- Patented prism structural design and manufacturing process to ensure excellent optical performance;
- Strict LED color management to ensure the consistency of light color;
- Consisting dimming curve to comply with FAA standard;
- Patented drive circuit and thermal management scheme greatly improve the reliability and service life of lighting fixtures;
- Power factor above 0.9, minimizing the grid interference;
- Interchangeable, modular-designed components, applicable for all series of 8-inch LED in-pavement omnidirectional lights;
- Specially designed structure, protrusion over pavement is less than 6.3mm;
- Upper cover with flat out-light surface to prevent water from building up and ensure high luminous efficiency;
- Main structure made of corrosion-resistant aluminum alloy with special anodizing treatment, all fasteners are made of stainless steel, suitable for harsh environment application;
- IP68 Ingress protection-grade, that can withstand inner pressure of up to 138kpa or water pressure generated from aircrafts' impact on the optical window.

Structure

1. Upper cover
2. Lighting fixture gasket
3. Prism
4. Prism gasket sleeve
5. Prism gasket
6. LED lamp assembly
7. Prism pressing bracket
8. Light body gasket
9. Inner cover assembly

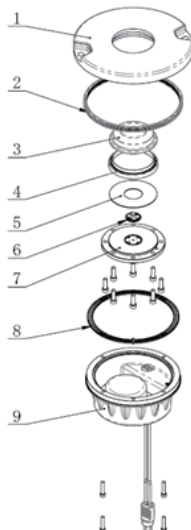

Ordering Information

FATOS-LED-066-C

Type _____
 FATOS=Inset Final Approach & Takeoff Light

Light source _____
 LED=LED light source

Power supply _____
 066=6.6A

Beam color _____
 C=White

* Please provide detailed installation info while ordering, spare parts and accessories should be separately ordered with specific order no.

Installation

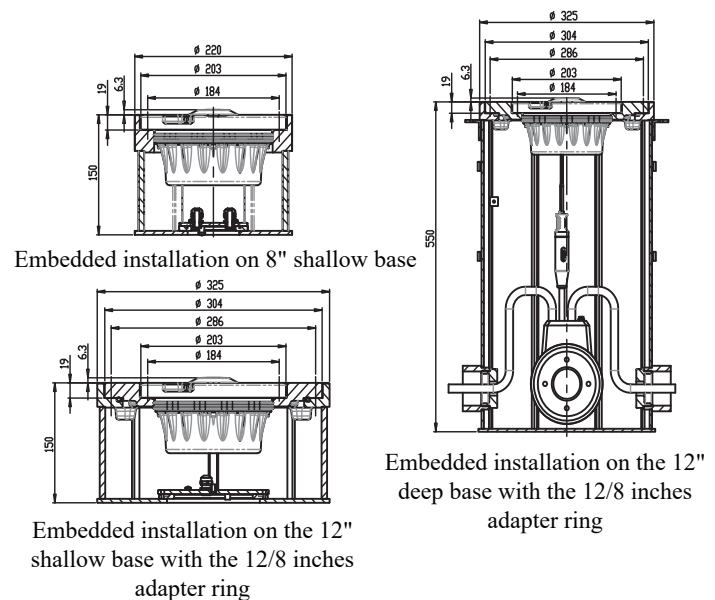

* Please find detailed information in installation manual

FATOS-LED

LED Inset Final Approach & Takeoff Light

Specifications

Light source: one White LED particle
 Power : 18 VA
 IP Grade: IP67

Photometric Data

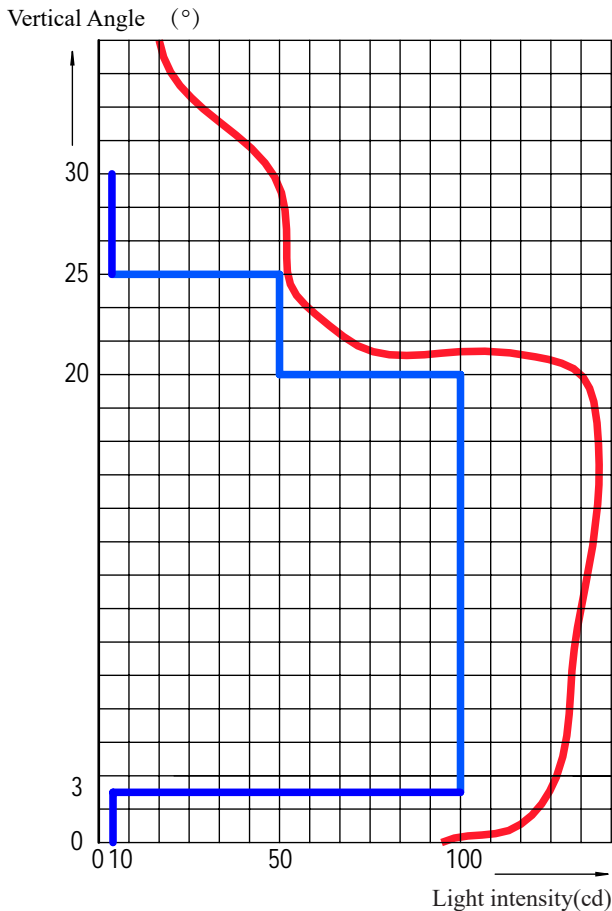

LED Final Approach & Takeoff Light(white),
 AC-137-CA chapter 5.2.1.5
 (vertical coverage of main beam 0° - 30°)

Application		Main Beam		Color	Required Min.	Actual Min.
		H	V			
FATOS	AC-137-CA 5.2.1.5	360°	0°- 3°	white	10	83
		360°	3°-20°	white	100	108
		360°	20°-25°	white	50	90
		360°	25°-30°	white	10	48

Spare Parts

Struc No	Part Name	Order No	Description
2	Light gasket	41107	Sealing tape (standard)
3	Prism	31114	Omni- prism (LED3-20°) 52°
4	Prism gasket sleeve	43115	Prism gasket sleeve
5	Prism gasket	43313	Prism gasket 66x51
6	LED lamp assy	79271-C	LED white
7	Prism pressing bracket	43217	Prism pressing bracket 108
8	Light body gasket	41141	Gasket 137x2
9	Inner cover assy	921251	6.6A

Accessories

No	Order No	Description
1	SB-08	Shallow base (8-inch)
2	SB-12	Shallow base (12-inch)
3	DB-12	Deep base (12-inch)
4	AR/12-08	Adaptor ring 12-8
5	951101	Lamp holder of 8-inch light
6	ITF	Isolation transformer
7	REC-7	Secondary cable connector style 7
8	95111-T	Base mounting bracket (telescope version)

Packing Data

Packaging: 1pc/box
 Gross weight: 3.0 KG/box
 Volume: 210*210*130 mm³

Packaging: 1pc/box (with 8-inch base)
 Gross weight: 6.0 KG/box
 Volume: 250*250*185 mm³

* All rights reserved, subject to modifications

FATOS-LED
2
2