

Compliance with Standards

CAAC:AC-137-CA-2017-01-R1
 SAC: GB/T 7256
 ICAO: Annex 14, Volume II
 FAA: AC 150/5345-46 & EB NO.87

Application/Use

LED Touchdown and Lift-off Area Perimeter Light of Heliport

Features

- Long working life LED, energy conversation, maintenance-free, which brings enormous economic benefits to customers;
- Special designed LED lens is adopted to greatly improve LED light efficiency;
- Patented prism structural design and manufacturing process to ensure excellent optical performance;
- Strict LED color management to ensure the consistency of light color;
- High reliability electronic components to match LED as long as possible;
- Bevel design of prism to prevent snow accumulation;
- Frangible parts are processed by high precision machine tools, T6 heat treatment to ensure stable performance;
- Main structure is made of corrosion-resistant aluminum alloy with electrostatic powder coating, all fasteners are made of stainless steel, suitable for harsh environment application;
- Consistent dimming curve to comply with FAA standard;
- The main body of the light fittings is designed with sealing, long service life, simple and safe maintenance.

Structure

- 1.Upper cover
- 2.Prism gasket sleeve
- 3.Prism
- 4.Light body gasket
- 5.Prism gasket
- 6.LED lamp assy lens
- 7.LED lamp assy
- 8.Prism pressing bracket
- 9.Driver
- 10.transformer
- 11.Light body
- 12.A6 Plug

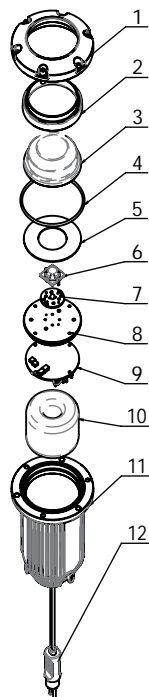

Ordering Information

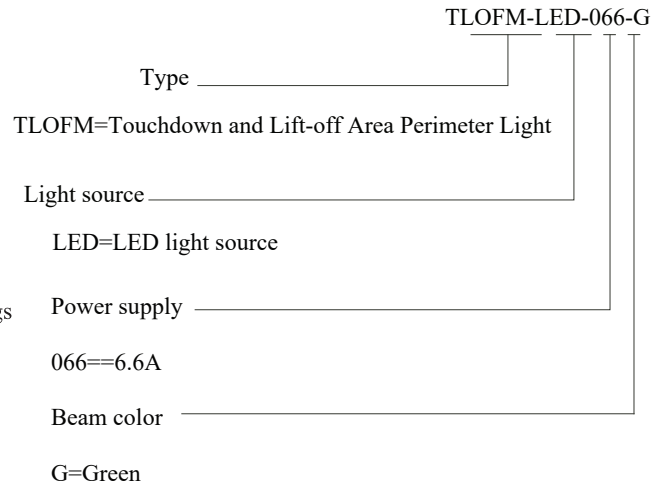

* Please provide detailed installation info while ordering, spare parts and accessories should be separately ordered with specific order no.

Installation

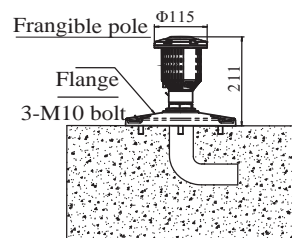

Installation with flange

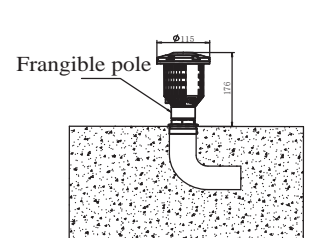

Installation with embedded parts

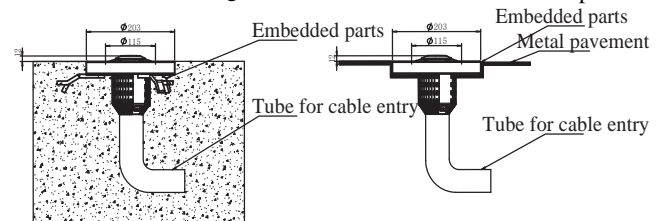

Bracket type installation of concrete pavement

Bracket type installation of metal pavement

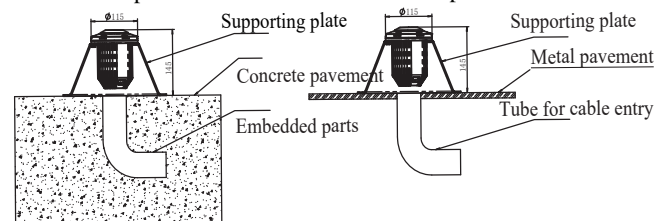

Embedded installation of concrete pavement

Embedded installation of metal pavement

* Please find detailed information in installation manual

■ TLOFM-LED

■ LED Touchdown and Lift-off Area Perimeter Light

Specifications

Light source: one Green LED particle
Power : 10 VA
IP Grade: IP65

Photometric Data

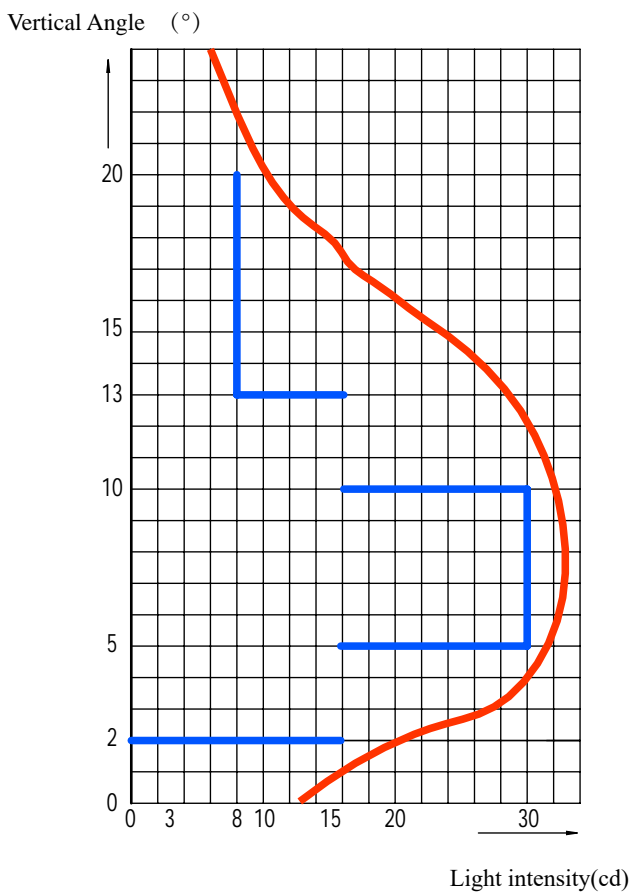

LED Touchdown and Lift-off Area Perimeter Light(green),
AC-137-CA chapter 5.2.1.3

(vertical coverage of main beam 0° - 90°)

Application		Main Bean		Color	Required Min.	Actual Min.
		H	V			
TLOFM	AC-137-CA 5.2.1.3	360°	2°- 5°	green	15	27
		360°	5°-10°	green	30	40
		360°	10°-13°	green	15	37
		360°	13°-20°	green	8	19
		360°	20°-90°	green	3	6

Spare Parts

Struc No	Part Name	Order No	Description
2	Prism gasket sleeve	43115	LED omni- prism gasket sleeve
3	Prism	31113	Omni- prism (LED3-20°) 52°
4	Light body gasket	41187	O-ring 85×2.65
5	Prism pressing gasket	43311	Prism gasket 81
7	LED lamp assy	79245	LED green
9	Driver	79133	6.6A
10	Transformer	ITF-025-066	25W
12	A6 plug	70602	M12

Accessories

No	Order No	Description
1	PLG6	A7 two core socket (assembly) - flat 1130
2	FL-10	Flange 240
3	54101	Hexagonal wrench for frangible pole of elevated lighting fixture
4	924231	Frangible Pole (HX)
5	4660X	Supporting plate 255x118
6	60905	Embedded parts 203

Packing Data

Packaging: 4pc/box
Net weight: 1.3 KG/box
Gross weight: 5.2 KG/box
Volume: 300*255*380 mm³

* All rights reserved, subject to modifications