

TDZZ-08-LED

Touch Down Zone Light (8-inch 6mm)

ICAO Annex 14, Vol I
IEC TS 61827
FAA AC 150/5345-46
FAA EB No.67

NATO STANAG 3316
CAAC AC-137-CA-2015-01
CAAC AC-137-CA-2015-03
SAC GB/T 7256



Features

- The serialized design of lighting fixtures and modular design of components effectively reduce the inventory of spare parts.
- The upper cover is made of forged aluminum alloy, high strength, good fatigue resistance combining excellent corrosion resistance and heat dissipation properties.
- Prism sealing sleeve with multi-layer waterproof sealing structure design and easy to replace.
- Low energy LED light source, with a comprehensive lifespan of not less than 100,000 hours and light attenuation is less than 30%.
- Strict LED color management ensures a high degree of consistency in the chromaticity output of lighting fixtures.
- The dimming curve complies with the requirements of FAA EB67, and the dimming characteristics of the luminaire are similar to those of traditional halogen light source luminaires.
- The overall degree of protection is IP68, capable of withstanding an internal pressure of 138KPa or the water pressure generated by the impact of aircraft tires on the window.
- Optional fault detection function, which can achieve light fault open circuit in case of light source or drive failure.
- Optional specialized arctic kits.
- The rated light beam output and heating function can be remotely configured through a set of CCRLight level encoding instructions.

Structure

1. Upper cover
2. Prism seal
3. Prism
4. Reflector
5. LED light source
6. Arctic kits
7. Prism pressing bracket
8. Driver module
9. Inner cover assembly
10. Light body gasket
11. Light fixture gasket

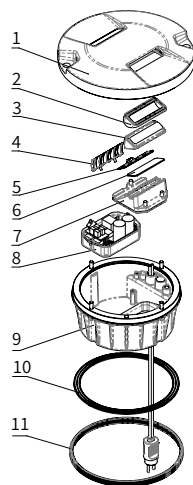

Ordering Information

TDZZ - 08 - LED - XX - X - X

Application

TDZZ= Touch Down Zone Light
08 = 8-inch in-pavement light

Lamp source

LED = LED source

Beam Toe-in

L = Toe-in left
R = Toe-in right

Beam color

C = Clear

Options

M = Failure open function
A = Arctic kit

*Please provide detailed installation information while ordering, spare parts and accessories should be separately ordered with specific order No.

Dimension

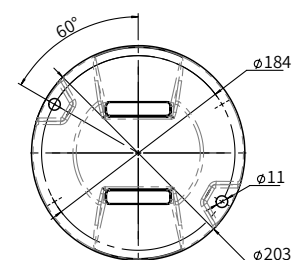
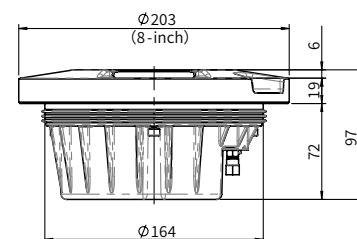

TDZZ-08-LED

Touch Down Zone Light (8-inch 6mm)

Environmental Parameters

Altitude	below 4,500m
Operating temperature	-55°C ~ +55°C
Degree of protection	IP68
Relative humidity	100%
Seismic basic intensity	VII

Electrical Parameters

Rated Power	16VA
Power Arctic	8VA (power not change under 2.8A to 6.6A)
Power Factor	>0.90
Power supply	2.8A ~ 6.6A

Photometric Data

Execution standard	Main beam		Beam Color	Required main beam average intensity (cd)	Typical average intensity (cd)
	H	V			
ICAO Figure A2-5 (FAA L-850B)	±5° toe-in 4°	2° to 9°	Clear	5,000	6,024

Packing Data

Quantity	1×Light (w/o base) /Carton box
Packing Size	210×210×130mm ³
Net weight	3.4kg
Gross Weight	3.5kg

Isolation Transformer Power

When selecting an isolation transformer, it is necessary to comprehensively consider the power of the light fixture, power loss of the secondary cable, power of the arctic kits (if equipped), and power of the single-lamp monitoring device (if equipped).

*At an ambient temperature of 20°C, the power loss of the secondary cable is approximately 0.6 W/m for a 2.5 mm² cross-section and 0.38 W/m for a 4 mm² cross-section under a current of 6.6 A.

*For light fixtures equipped with arctic kits, note that under normal conditions, the electric heating power remains constant within the current range of 2.8 A to 6.6 A.

*If a single-lamp monitoring device is to be connected, pay attention to its power characteristics within the current range of 2.8 A to 6.6 A.

Spare Parts

Struc No.	Part Name	Order No.	Part Name
2	Prism seal	43123	Prism seal 65×26×H5.2
3	Prism	3115D	Prism 65×26×H5.2
4	Reflector	3205D	Reflector-F5-4-H16
5	LED light source	7927N-RCLZ-C	LED assembly-RCLZ-C clear
6	Arctic kits	791B4	Resistance 62×18
8	Driver module	9791AX-I-2W	Driver module 2-way
		9791AX-I-2W-A	Driver module 2-way with Arctic
		9791AX-MF-2W	Driver module 2-way with FOD
		9791AX-MF-2W-A	Driver module 2-way with FOD with Arctic
10	Light body gaske	41141	Light body gasket 137×2
11	Light fixture gasket	41107	Standard sealing tape for 8-inch lights

Accessories

No.	Order No.	Description
1	SB-08	8"shallow base
2	SB-12	12"shallow base
3	AR-12/08	12"-8" base O-ring
4	951101	8"lamp handle
5	ITF-XXX-066	isolation transformer
6	REC7	moulded type secondary cable receptacle style 7

